



Super Fat Cat-LCS

ASSEMBLY INSTRUCTIONS AND OWNER'S MANUAL



This owner's manual will help you with initial set up of your new float tube, provide basic safety information, review boat maintenance tips, plus cover some simple field repairs. Please review this material and familiarize yourself with the craft before using it.

If this is your first float tube please consult with your local dealer to ensure that you are comfortable operating this craft safely.

PLEASE KEEP THIS MANUAL IN A SECURE PLACE AND TRANSFER IT TO THE NEW OWNER IF YOU SELL THIS BOAT.



WARNING

Always wear a government approved flotation devise.

Know the limits of your ability and the limits of your equipment.



BEFORE YOU BEGIN...

Check for damaged or missing parts. (See page 2)

Outcast Sporting Gear, P.O. Box 186, Meridian, ID 83680
Ph. (800) 966-0976 - Fax. (208) 955-0477 - E-mail: info@outcastboats.com
Monday - Friday 8 a.m. - 5 p.m. MST

Table of Contents

SUPER FAT CAT-LCS ASSEMBLY INSTRUCTIONS

Items Included	2
Inflation Instructions	3-4
LCS Stripping Apron Installation	4

OWNER'S MANUAL

Transporting	5
Cleaning	5
Storage	5
Basic Trouble Shooting	5
Basic Field Repair	6-7
Warranty	7
Tear Aid Instructions	8

Items Included:



1 - Super Fat Cat-LCS Float Tube



1 - LCS Stripping Apron



1 - Repair Kit

Repair Kit Contains:

****Glue Not Included****

- 1 - 6" X 6" Pack Cloth Fabric
- 1 - 6" X 6" PVC Fabric
- 1 - 6" X 6" UCN
- 2 - 6" X 6" Urethane Material
- 1 - Vinyl Tubing Adapter
- 1 - Summit 2 Valve Adapter
- 1 - Summit Valve Wrench
- 3 - Tear Aid™ Patch Type A
- 2 - Alcohol Prep Pad
- 1 - Tear Aid Instructions
- 1 - Piece Sandpaper

Item Needed for Inflation: (not included)



1 - Hand Pump

Float Tube Inflation

Items needed:



1 - Super Fat Cat-LCS



1 - Hand Pump



1 - Vinyl Tubing and Summit 2 Adapter

1. Place the deflated Super Fat Cat-LCS on a flat surface.
2. Close the Summit 2 valve by pressing and turning the valve stem 1/4 turn clockwise. This will position the valve stem in the up or closed position.
3. Using the Hand Pump, vinyl tube adapter and the Summit 2 valve adapter, inflate the float tube until the cover fills out firm and evenly, approximately 1.8 psi.



If at any point during the inflation process the float tube appears to look disfigured, stop and release the air from the float tube, then unzip the float tube and straighten the interior bladder. Once adjustment to the bladder has been completed, carefully close the zipper and re-inflate.

Seat Bottom Inflation

Items needed:



1 - Super Fat Cat-LCS



1 - Hand Pump



1 - Vinyl Tubing Adapter



4. After locating the seat bottom inflation tube, connect the hand pump with vinyl tube adapter and inflate the seat bottom to a firm pressure.

Seat Back Inflation

Items needed:



1 - Super Fat Cat-LCS



1 - Hand Pump

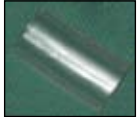

1 - Vinyl Tubing Adapter

5. After locating the seat back inflation tube, connect the hand pump with vinyl tube adapter and inflate the seat back to a firm pressure.
6. Secure seat cover flap by threading the webbing through the ladder lock buckle. Repeat for opposite side. (See detail below)



CAUTION

Changes in air temperature and elevation may cause the air to inside the float tube expand and could cause it to burst.

Never leave your fully inflated float tube sitting in direct sun out of the water.

ALWAYS RELEASE SOME AIR WHEN THESE CONDITIONS OCCUR.

To deflate: Depress the valve stem and turn 1/4 turn counter-clockwise. This will position the valve in the down/open position.



Ladder Lock Detail

LCS Stripping Apron Installation

Items needed:



1 - Super Fat Cat-LCS



1 - LCS Stripping Apron



Detail of pocket location for apron stays

7. Secure left side apron stays into the stay pockets on the Super Fat Cat-LCS. The rear apron stay pocket is located 5" from the front edge of the seat.
8. Once seated in the Super Fat Cat-LCS, insert right side of apron stays.

Owner's Manual

Transporting

To avoid excessive wear and extend the life of this craft we recommend transporting this craft in a Outcast Sporting Gear boat bag or cover with clean, dry tarp. Do not load other equipment, particularly heavy or sharp objects, on top of the craft. If you transport your boat in an open truck bed please make sure all sharp objects are removed because more boats are damaged in transport than on the water.

****VALVE CAPS SHOULD ALWAYS BE IN PLACE WHENEVER TRANSPORTING YOUR BOAT.****

Cleaning and Maintenance

Your inflatable boat is constructed with high quality materials and superior workmanship however, as with all outdoor equipment proper cleaning and maintenance will extend the use of the product and allow it to perform better. Most damaging to your inflatable boat are extended UV exposure, insect repellents, plus mold and mildew. To keep your boat performing its best please following these simple instructions.

- Do not set your boat on sharp objects.
- Do not over inflate your boat.
- Keep the zippers clean.
- Clean the boat with soap and water.
- Allow the boat to drain properly so it can be stored dry.

Storage

Short Term Storage - Allow to air dry, deflate and roll loosely

Long Term Storage - **Store your boat dry and clean.** After use, rinse off all debris and allow the boat to air dry on soft pressure and out of direct sunlight. Residual water inside the bladders/airecells will not damage the boat. Store the boat in a cool, dry place out of sunlight and away from exhaust fumes. If you store your boat inflated you should be able to pinch an inch of material, but not to operating pressure is the best.

Basic Trouble Shooting

1. *Valve does not retain air when pump is removed.*
 - Make sure that the valve stem is in the up or closed position.
 - Clear any debris that might be preventing the valve from sealing. This can be accomplished by either pumping quick bursts of air into the valve or removing the core valve assembly and cleaning the edge of the rubber diaphragm with a cotton swab and denatured alcohol.
 - Make sure that the core valve assembly is tight. Tighten with valve wrench if necessary.
2. *Tube becomes soft after inflation process.*
 - Determine which air chamber is soft. Make sure the valve is functioning correctly, with no signs of leaking. (See above)
 - Find the hole in the airecell and patch with the Tear Aid patch.
3. *Tube is puckered or shows a void when inflated.*
 - The airecell might be misaligned. Deflate the tube(s) and as they are brought back up to pressure, manipulate the tube(s) to free the airecell as it inflates. If this does not fix the problem, deflate the boat, open the zipper and adjust the airecell.
4. *Zipper is difficult to operate.*
 - Use a combination of soap, water and an old toothbrush to clean and clear the zipper of debris.
5. *Tear Aid patch does not stick to airecell.*
 - Make sure the area to be patched is dry and clean. Use the alcohol pad to prep the area, if necessary.

Owner's Manual

This boat contains a starter repair kit that includes equipment for basic repairs.

The Repair Kit Contains

1 - 6" x 6" Pack Cloth
1 - 6" x 6" UCN Material
1 - Vinyl Tubing Adaptor
2 - Alcohol Prep Pads

1 - 6" X 6" PVC Material
1 - Summit Valve Wrench
1 - Piece Sandpaper
1 - Tear Aid Instructions

2 - 6" X 6" Urethane Material
1 - Summit 2 Valve Adapter
3 - Type A Adhesive Patches

Here is a list of items, not included, which you should strongly consider keeping with your repair kit at all times.

*1/4 pint Stabond 2-part adhesive
Roller
Duct tape
Standard Screwdriver

Scissors or knife
MEK solvent
Old toothbrush

Small paintbrush
Towel
Popsicle stick or tongue depressor

*It is recommended that the glue be replaced every year.

Repair Tips

Prior to opening the boat's zippers, make sure they are clean and clear of any debris so that they will operate freely, by cleaning the zippers with soapy water and an old toothbrush.

When patching the airecell, apply the patch to the outside of the airecell. When patching the PVC shell, apply the patch on the inside of the PVC. The airecell patch is for air retention. The PVC shell patch protects the airecell patch as well as prevents the hole from tearing further.

Adhesive Patch Repair

Items needed:

Towel	Alcohol Prep Pad
Type A Adhesive Patch	Tear Aid Instruction Sheet

For most repairs, the airecell does not need to be removed completely.

1. Locate the hole in the boat and access that area of the airecell and outer skin by opening the zipper.
2. Using a towel, dry the area to be worked on.
3. Clean area to be worked on with alcohol prep pad and let the area air dry.
4. Peel backing paper off Type A Adhesive Patch and apply patch over punctured area. (See Tear Aid instruction sheet for more details.)
5. Press and rub patch so that the patch seals completely and is without bubbles.

Glue Repair

Items needed:

Scissors or knife	Slotted Screwdriver	Roller
Stabond 2-part adhesive	Sandpaper	Popsicle stick
Small brush	PVC Material or Vinyl Material	MEK or Alcohol Prep pads

For most repairs, the airecell does not need to be removed completely.

When patching the airecell, apply the patch to the outside of the airecell. When patching the PVC shell, apply the patch on the inside of the PVC.

Owner's Manual

1. Locate the hole in the boat and access that area of the airecell and outer skin by opening the zipper.
2. Using a towel, dry the area to be worked on.
3. Cut a patch of fabric at least two inches larger in length and width than the puncture, hole, or tear.
4. Clean the area to be patched (using MEK or alcohol prep pads).
5. Rough up both the patch and the area to be patched with the sand paper.
6. After opening the 2-part adhesive, prepare the Stabond glue by pouring the entire contents of the glass jar into the metal can and stir using a popsicle stick or tongue depressor.
7. Apply an even coat of glue with a small brush to both the patch and the area to be repaired and let dry completely, approximately 10-15 minutes.
8. Apply a second coat of glue, and let dry 5 minutes or until tacky. If the glue is too dry, dampen with a small amount of cleaner.
9. Place the patch over the hole or tear, and press together. Using a roller or another blunt object press from the center of the patch to the edges to seal the patch to the airecell or outer skin. Make sure that the patch seals completely and is without bubbles.
10. Let the glue cure at least one hour before inflating (overnight if possible is best). Do not inflate to full pressure on the same day of the repair.

The Ultimate Extended Trip Repair Item

The ultimate repair part for any boat is an extra airecell.

Extensive Repairs

If you have a major rip or tear in your boat that is beyond your abilities to repair, please contact Outcast Sporting Gear at 800-966-0976 for a Return Authorization (RA) number. Please put a brief note with your contact information and a detailed description of the repairs necessary inside the box and ship the package to the address below with the RA number clearly written on the outside of the box. For your protection, please ship the boat with a service that provides a tracking number.

Warranty

This warranty covers defects in materials and workmanship only for a period of 5 year from the date of purchase for the original owner.

If you experience a problem with the boat, please contact Outcast Sporting Gear at 800-966-0976 for a Return Authorization number. Repairs not covered under the warranty will be made to the boat for a small fee.

Outcast Sporting Gears reserves the right to determine whether to repair or replace any product covered by this warranty and the right to replace any discontinued models with current models when necessary. Colors may vary between original and replacement parts.

If you have any questions, please contact your nearest dealer or
Outcast Sporting Gear, 2021 E. Wilson Lane, Meridian, ID 83642, 800-966-0976
www.outcastboats.com

Thank you for choosing Outcast Sporting Gear products.

TEAR-AID® APPLICATION INSTRUCTIONS

REPAIRING GENERAL TEARS AND HOLES

For best results apply to a clean, dry surface. Clean the surface to be repaired with an alcohol prep pad, or a 50/50 mixture of rubbing (isopropyl) alcohol and water. **Before proceeding make sure surface is dry, and you have the correct patch type for the kind of material you are repairing.**

Surface temperature of the materials to be repaired should be 50° F or warmer. Do not put repaired material into a washer or dryer.

- STEP 1. CUT:** Cut patch to size with scissors allowing for the patch size to extend 1 inch beyond all edges of the tear. If using more than one patch, allow for patch sizes to overlap at least 1 inch. Trim square corners into rounded corners.
- STEP 2. PEEL:** Carefully peel back ½ inch of paper liner. Tearing the paper liner while stretching the edge of the patch will help to separate the liner from the patch - especially when the patch has been cut into smaller sizes.
- STEP 3. STICK:** Position and anchor exposed ½ inch edge – allowing the patch to extend 1 inch beyond all edges of the tear. Slowly peel back the liner while carefully applying the patch over the tear – take care to avoid air bubbles. Rub all edges to seal. Rub entire patch aggressively. Repair is complete.

REPAIRING TEARS EXTENDING THROUGH AN OUTSIDE EDGE

Follow steps 1 thru 3 with the following adjustments:

Cut the patch size to extend a full 1 inch beyond the edge of the torn material.

Peel and Stick, positioning the patch **leaving a 1 inch tab extended beyond the outside edge** of the torn material.

- STEP 4. Turn the material over**, so that the adhesive side of the tab is facing up.
- STEP 5. Position reinforcement filament** tightly against the outside edge of the material by sticking it to the patch tab. The filament should be perpendicular to the open end of the tear to create a tough solid edge.
- STEP 6. Fold over** the patch's 1 inch tab and rub to adhere to the backside of the material – sealing in the reinforcement filament.
- STEP 7. Apply another patch** to the backside of the patched tear (so that both sides of material are patched) Rub entire patch aggressively.
- STEP 8. Trim excess line.** Repair is complete. (80lb Test Fishing line is our suggested reinforcement filament line)

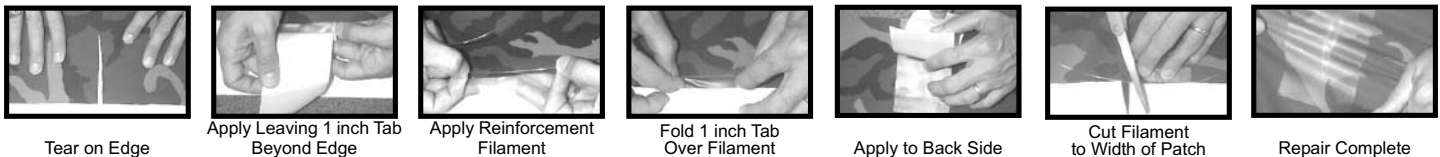

REPAIRING HOLES ON GROMMET MATERIAL (TIE-DOWN RINGS/HOLES)

Follow steps 1 thru 8 with the following adjustments:

Cut the patch size to extend a full 3 inches beyond the edge of the torn material.

Peel and Stick, positioning the patch centered over the existing ring/hole **leaving a 3 inch tab extended beyond the outside edge** of the torn material.

If necessary, replace the grommet (tie-down ring) by placing a new grommet into position before applying the patch and folding the tab over the reinforcement filament.

Carefully cut a hole inside the ring by using a clean, sharp blade to trim the Tear-Aid® repair patch from inside the grommet. Rub the new hole edges aggressively. Repair is complete.

HEATING IS AN OPTION AND NORMALLY NOT NEEDED.

HEAT TO SPEED UP CURING TIME (OF VINYL-ONLY TYPE B)

For Tear-Aid® Vinyl-Only Type B - to transform the good initial bond to an extremely high bond that would otherwise take 24 hours of curing time - After the patch is applied to the tear, heat to a range of approximately 180° F to 350° F with a heat gun briefly. **Heat time will vary depending on size of patch.** As the adhesive hot melt occurs, the patch see-thru clarity may change and appear easier to see-thru. **Allow repair to cool before handling.**

HEAT TO IMPROVE BONDING OF PATCH TYPE A TO UNEVEN, UNUSUAL, OR HARD-TO-ADHERE-TO PRODUCTS

For Tear-Aid® Original Type A - Initial adhesion is extremely high. After the patch is applied to the tear - heat to a range of approximately 180° F to 350° F with a heat gun briefly. **Heat time will vary depending on size of patch.** As the adhesive hot melt occurs, the patch see-thru clarity may change and appear easier to see-thru. This will improve bonding to hard-to-adhere-to products like non-corona treated polyurethane and some unusual synthetic fabrics. **Allow repair to cool before handling.**

